

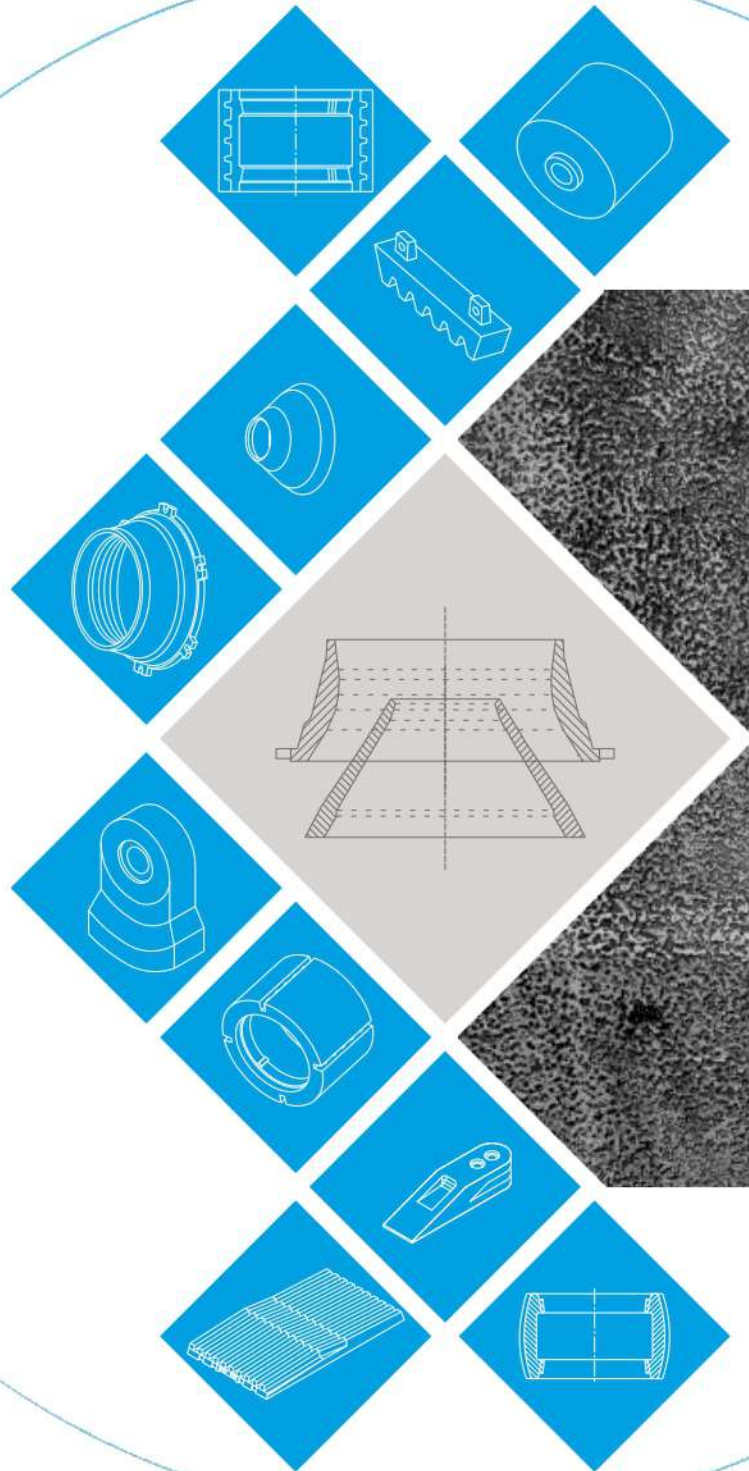

**SHRI RAJESHWARI**  
**Industrial Essentials**



[www.shrirajeshwariindustries.com](http://www.shrirajeshwariindustries.com)



# INTRODUCTION

We take this opportunity to introduce our self as the leading manufacturer of High Manganese Steel, Carbon Steel, High Chrome Steel, Phosphor bronze Steel Casting. In High Manganese we Produce Concave Mantle, Jaw, Cheek Plate, Excavator Teeth , Wedges etc In High Chrome we Produce Liners, Blow Bars, Hammer, Grinding media, etc In Carbon Steel we produce Cone Crusher Body, Jaw Crusher Body, Gears and other castings. In Phosphor bronze Steel Casting we produce Thrust Plate, Bush etc for both National and International Brands. SR INDUSTRIES is a part of SISODIYA group who is into Infrastructure Technology Sector, Real Estate sector, Steel Sector, Crushing & Mining Sector. SR INDUSTRIES Is One of the Biggest Foundry In North India With The Capacity of 1800 MT Per Month from 2 (Two) Plant and the single piece weight of 5000 Kg. As a part of our expansion program and to achieve the best Quality product we installed all the Latest Technology & equipment available In the World today like Stationery Spectrometer, XSORT Hand Held XRF Spectrometer, Automatic Hardness tester, Hexagon Romer Absolute arm, PolyWorks Reverse Engineering Software, universal testing machine (UTM), microscope ,vertical turning lathe (VTL), horizontal turning lathe (HTL), Plano miller etc Our quality inspection commence from the selection of the scrap to the selection of Ferro Alloys and to the selection of the best method for the casting. For other parameters matching the ISO standard as near as possible. SR INDUSTRIES is an ISO 9001-2008 certified company. Our original purpose to set up our foundry was to serve and meet requirement of our own mine/crusher. After noticing the demand of our products in the market due to inherent good quality, accuracy in measurements and most competitive price, we increased the capacity of our foundry to meet the market demand. Our quality improved with continuous development of R & D exercise. Look, long life expectancy and timely availability of our quality products & competitive price. We in SR INDUSTRIES nurture a corporate culture based on quality, trust, reliability. Our company main aim is to produce the best quality product in the most efficient way.

## OUR SPECIALIZATIONS IN



**STONE CRUSHER PLANT PARTS**



**THERMAL POWER PLANT PARTS**

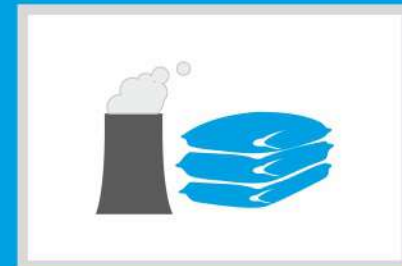

**CEMENT PLANT PARTS**



# SHRI RAJESHWARI Industrial Essentials

## PATTERN SHOP

We develop the pattern as per the drawing furnished to us by the buyer in our in-house pattern shop. This facility ensures timely manufacture and 100% accuracy in measurements.



## PRODUCT WEIGHT RANGE

Maximum casting weight per piece 5 M.T. (5000 kg.) (11023 lbs)  
minimum casting weight 5 kg. (11 lbs.).

## PRODUCTION CAPACITY

Our Plants are efficient for quality production capacity of 1800 m.t. per month.

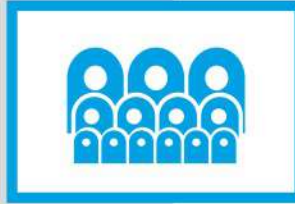

## SHIPMENT

We can supply 40 fcl (20 ft. Container) to single customer, however the figures may be revised after mutual discussion.

## CASTING TECHNIQUE

With more than 10 year of long experience. We enjoy the specialization in sand casting (No Bake sand, Silica Sand, Oliven Sand, Shell Sand Etc) Die Casting, Centrifugal Casting Etc and we are capable of casting any customize patterns ranging from 5 Kg. (11 Lbs.), 5 M.T. (5000 Kg.) (11023 Lbs.)

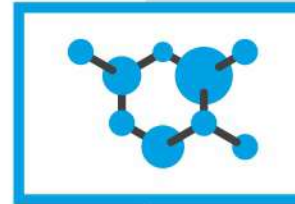

## ALLOY SECTION

With our in-depth knowledge of various alloys We manufacture Maganese steel casting, carbon Steel Casting, High chrome casting, Phosphor bronze Steel Casting, So the customer can choose any Grade in these Casting & We can Customize the Grades also.

## PRODUCT REDESIGN

Usually We develop the pattern and do casting as per the drawing furnished to us by the buyer but we also totally re design the product as per the customer requirnrment. We have a highly qualified team for product redesign who works on the latest design software Like Poly Works, Auto Cad, Catia Etc



## PRECISION

State-of-the-art 3D Scanners A) **Hexagon Absolute Romer Arm Scanner** & B) **Creaform Go!scan 50** ( with 0.04mm. & 0.100 mm Accuracy). To analysis & acquire the 3D data of any object which is scanned, which is further converted into 2D-Sectional Drawings with precise measurements to develop patterns/ Moulds.

**SR** OUR QUALITY TRAITS

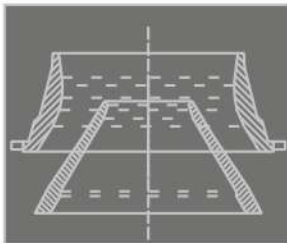

PATTERN SHOP  
MOULDING  
CLOSING  
MELTING  
FATTLING SHOP  
HEAT TREATMENT  
QUALITY  
GRINDING  
MACHINE SHOP  
ALLOYS



## CONCAVE MANTLE

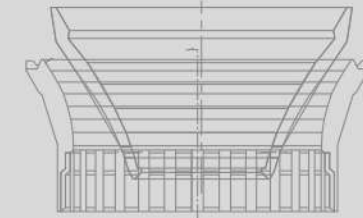

PRODUCT UTILITY	CONE CRUSHER
PRODUCT WEIGHT	5 MT (5000 KG) SINGLE PIECE
PRODUCT SIZE	DEPEND UPON THE CUSTOMER REQUIREMENT
PRODUCT RANGE	5 Kg. (11 Lbs.) to 5 MT (5000 KG)
PRODUCT FEATURES	ACCURATE, CONSISTENT, EFFICIENT, DURABLE AND COST EFFECTIVE
PRODUCT GRADE	HIGH MANGANESE STEEL CASTING



## JAW PLATE

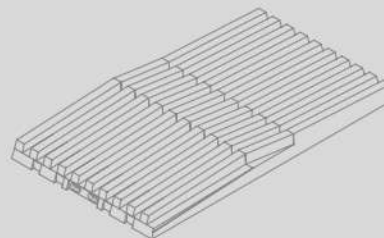

PRODUCT UTILITY	JAW CRUSHER
PRODUCT WEIGHT	5 MT (5000 KG) SINGLE PIECE
PRODUCT SIZE	DEPEND UPON THE CUSTOMER REQUIREMENT
PRODUCT RANGE	5 Kg. (11 Lbs.) to 5 MT (5000 KG)
PRODUCT FEATURES	ACCURATE, CONSISTENT, EFFICIENT, DURABLE AND COST EFFECTIVE
PRODUCT GRADE	HIGH MANGANESE STEEL CASTING





## BLOW BAR

PRODUCT UTILITY	HSI (HORIZONTAL SHAFT IMPACTOR)
PRODUCT WEIGHT	MAX 3 MT (3000 KG) SINGLE PIECE
PRODUCT SIZE	DEPEND UPON THE CUSTOMER REQUIREMENT
PRODUCT RANGE	5 Kg. (11 Lbs.) to 3MT (3000 KG)
PRODUCT FEATURES	ACCURATE, CONSISTENT, EFFICIENT, DURABLE AND COST EFFECTIVE
PRODUCT GRADE	HIGH CHROME STEEL CASTING

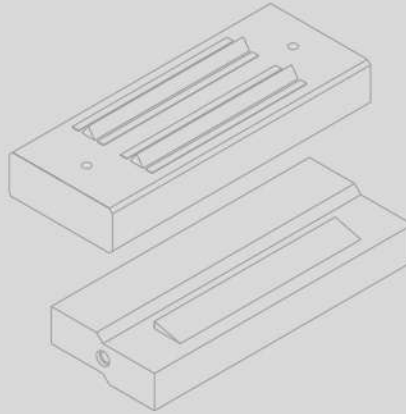

## HAMMERS

PRODUCT UTILITY	HSI (HORIZONTAL SHAFT IMPACTOR)
PRODUCT WEIGHT	MAX 3 MT (3000 KG) SINGLE PIECE
PRODUCT SIZE	DEPEND UPON THE CUSTOMER REQUIREMENT
PRODUCT RANGE	5 Kg. (11 Lbs.) to 3MT (3000 KG)
PRODUCT FEATURES	ACCURATE, CONSISTENT, EFFICIENT, DURABLE AND COST EFFECTIVE
PRODUCT GRADE	HIGH CHROME STEEL CASTING

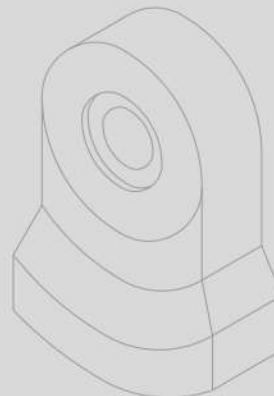

PRODUCT UTILITY	STONE CRUSHER / POWER PLANT / CEMENT PLANT/ MINES etc.
PRODUCT WEIGHT	VARIABLE WEIGHT
PRODUCT SIZE	DEPEND UPON THE CUSTOMER REQUIREMENT
PRODUCT RANGE	5 MT (5000 KG) SINGLE PIECE
PRODUCT FEATURES	ACCURATE, CONSISTENT , EFFICIENT, DURABLE AND COST EFFECTIVE
PRODUCT GRADE	CARBON STEEL CASTING

## CRUSHER BODY

CONE / JAW

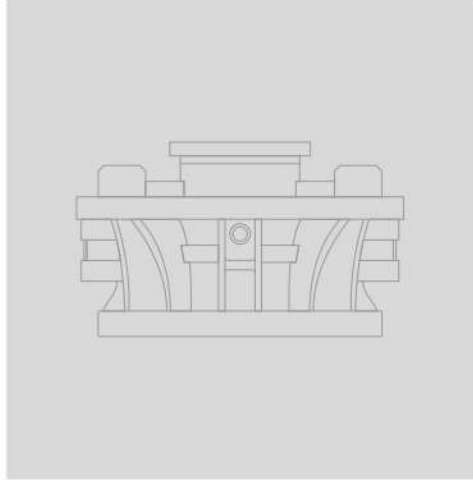

PRODUCT UTILITY	STONE CRUSHER / POWER PLANT / CEMENT PLANT/ MINES etc.
PRODUCT WEIGHT	VARIABLE WEIGHT
PRODUCT SIZE	DEPEND UPON THE CUSTOMER REQUIREMENT
PRODUCT RANGE	5 MT (5000 KG) SINGLE PIECE
PRODUCT FEATURES	ACCURATE, CONSISTENT , EFFICIENT, DURABLE AND COST EFFECTIVE
PRODUCT GRADE	CARBON STEEL CASTING

## GEARS

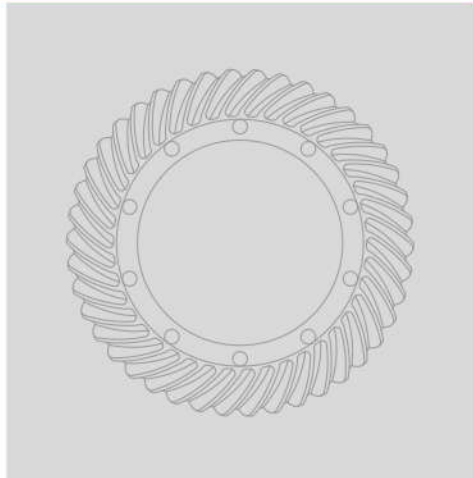



# BUSHES

PRODUCT UTILITY	CONE CRUSHER PART
PRODUCT WEIGHT	.3 MT (300 KG) SINGLE PIECE
PRODUCT SIZE	DEPEND UPON THE CUSTOMER REQUIREMENT
PRODUCT RANGE	VARIABLE PRODUCT
PRODUCT FEATURES	ACCURATE, CONSISTENT, EFFICIENT, DURABLE AND COST EFFECTIVE
PRODUCT GRADE	PHOSPHORUS BRONZE STEEL CASTING

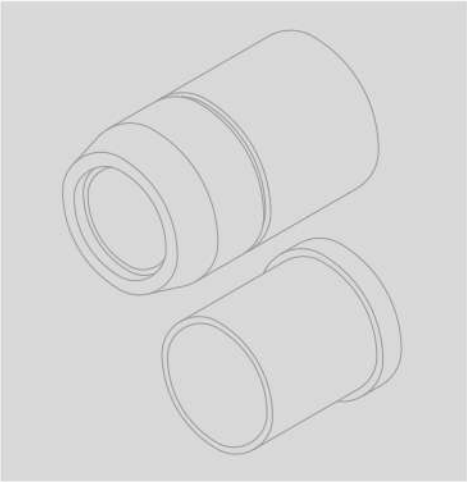

# THRUST PLATE

PRODUCT UTILITY	CONE CRUSHER PART
PRODUCT WEIGHT	.3 MT (300 KG) SINGLE PIECE
PRODUCT SIZE	DEPEND UPON THE CUSTOMER REQUIREMENT
PRODUCT RANGE	VARIABLE PRODUCT
PRODUCT FEATURES	ACCURATE, CONSISTENT, EFFICIENT, DURABLE AND COST EFFECTIVE
PRODUCT GRADE	PHOSPHORUS BRONZE STEEL CASTING

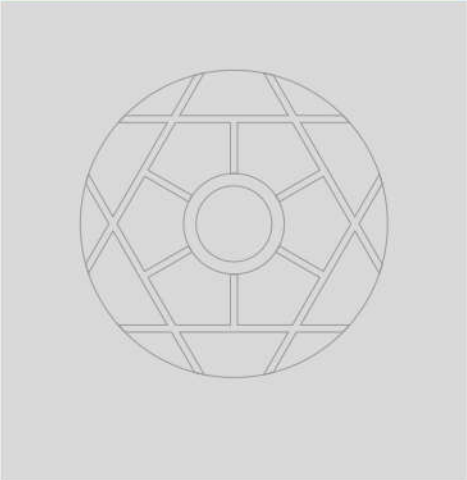



PRODUCT UTILITY	STONE CRUSHER / POWER PLANT / CEMENT PLANT
PRODUCT WEIGHT	VARIABLE WEIGHT
PRODUCT SIZE	DEPEND UPON THE CUSTOMER REQUIREMENT
PRODUCT RANGE	VARIABLE PRODUCT
PRODUCT FEATURES	ACCURATE, CONSISTENT, EFFICIENT, DURABLE AND COST EFFECTIVE
PRODUCT GRADE	HIGH MANGANESE STEEL CASTING & HIGH CHROME STEEL CASTING

## CHEEK PLATE / LINERS

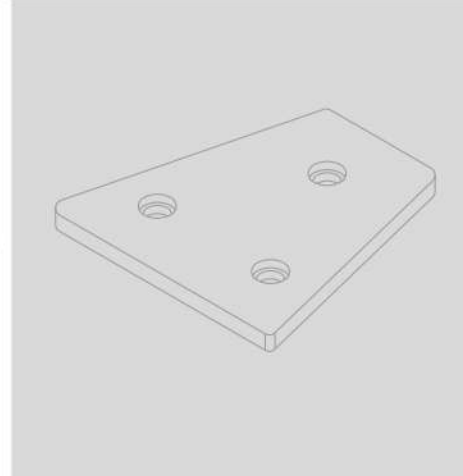

PRODUCT UTILITY	THERMAL POWER PLANT / CEMENT PLANT
PRODUCT WEIGHT	VARIABLE AS PER PRODUCT SIZE
PRODUCT SIZE	DEPEND UPON THE CUSTOMER REQUIREMENT
PRODUCT RANGE	10MM to 100 MM SIZE
PRODUCT FEATURES	ACCURATE, CONSISTENT, EFFICIENT, DURABLE AND COST EFFECTIVE
PRODUCT GRADE	HIGH CHROME STEEL CASTING

## GRINDING MEDIA

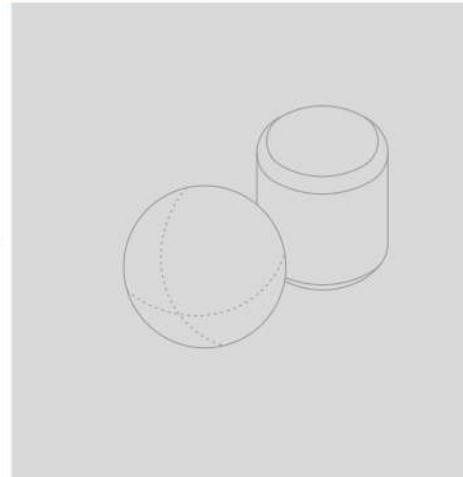
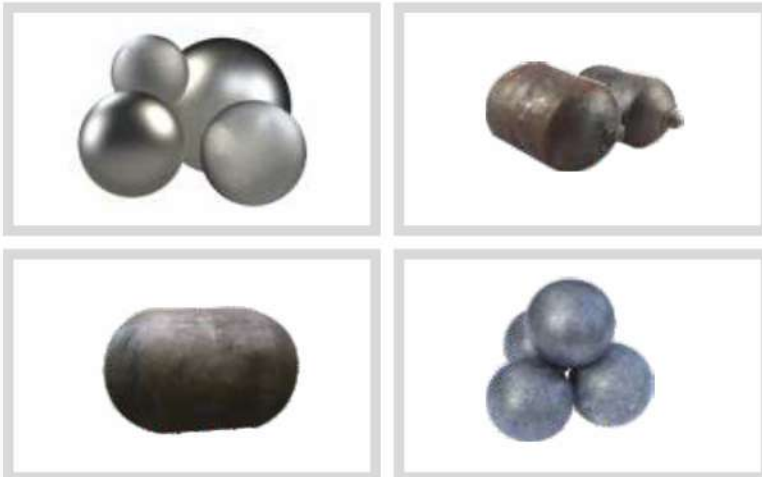



# WEDGES

PRODUCT UTILITY	JAW CRUSHER
PRODUCT WEIGHT	VARIABLE WEIGHT
PRODUCT SIZE	DEPEND UPON THE CUSTOMER REQUIREMENT
PRODUCT RANGE	VARIABLE PRODUCT
PRODUCT FEATURES	ACCURATE, CONSISTENT, EFFICIENT, DURABLE AND COST EFFECTIVE
PRODUCT GRADE	HIGH MANGANESE STEEL CASTING & HIGH CHROME STEEL CASTING

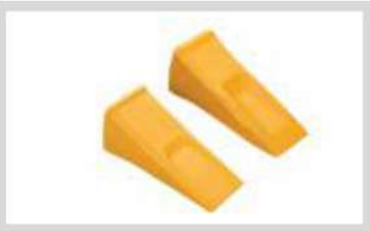
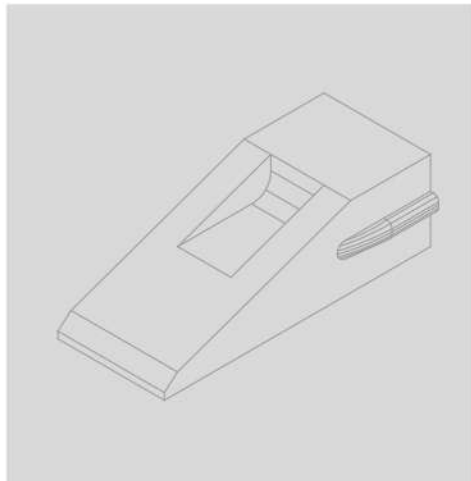

# EXCAVATOR TEETH

PRODUCT TYPES	STONE CRUSHER / POWER PLANT / CEMENT PLANT / MINES etc.
PRODUCT WEIGHT	1 MT (1000 KG) SINGLE PIECE
PRODUCT SIZE	DEPEND UPON THE CUSTOMER REQUIREMENT
PRODUCT RANGE	5 Kg. (11 Lbs.) to 1000 KG
PRODUCT FEATURES	ACCURATE, CONSISTENT, EFFICIENT, DURABLE AND COST EFFECTIVE
PRODUCT GRADE	HIGH MANGANESE STEEL CASTING & HIGH CHROME STEEL CASTING

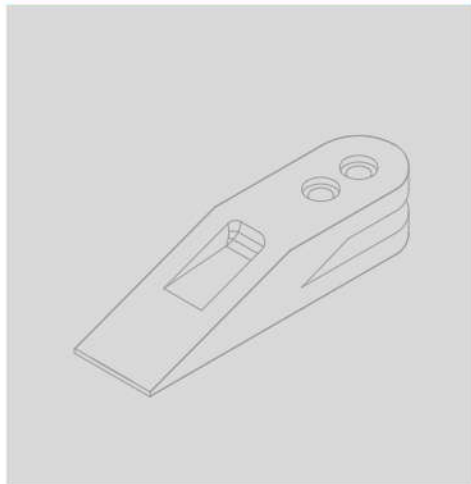

# CHEMICAL AND MECHANICAL COMPOSITION OF CASTING

## HIGH CARBON HIGH CHROME STEEL CASTING

ASTM SPECIFICATION	Bs4844	C (%)	Si (%)	Mn (%)	Ni (%)	Cr (%)	Mo (%)	HARDNESS	WAPL
A-532-IIA	3F/3G	2.0-3.3	1.5 Max.	2.0 Max.	2.5 Max.	11.0-14.0	3.0 Max.	600-650	WAPL-1
A-532-IIB	3A	2.0-3.3	1.5 Max.	2.0 Max.	2.5 Max.	14.0-18.0	3.0 Max.	600-650	WAPL-2
A-532-IIC	3B	2.8-3.6	1.0 MAX.	2.0 Max.	0.5-1.0	14.0-18.0	2.3-3.5	600-650	WAPL-3
A-532-IID	3C	2.0-3.3	1.0-2.2	2.0 Max.	2.5 Max.	18.0-23.0	3.0 Max.	600-700	WAPL-4
A-532-IIIE	-	2.6-3.2	1	2.0 Max.	105-2.0	18.0-23.0	1.0-2.0	600-700	WAPL-5
A-532-IIA	3D	2.0-3.3	1.5 Max.	2.0 Max.	2.5 Max.	23.0-30.0	3.0 Max.	600-700	WAPL-6

## AUSTENITIC MANGANESE STEEL CASTING

ASTM GRADE	C (%)	Mn (%)	Si (%)	S (%)	P (%)	Cr (%)	Mo (%)	Ni%	HARDNESS	BEND ANGLE
GRADE-1	1.05-1.35	11.0-14.0	1	0.08	0.025	-	-	-	229	150
GRADE-2	0.09-1.05	11.5-14.0	1	0.08	0.025	-	-	-	229	150
GRADE-3	1.05-1.35	11.5-14.0	1	0.08	0.025	1.5-2.5	-	-	229	150
GRADE-4	0.70-1.30	11.5-14.0	1	0.08	0.025	-	-	3.0-5.0	229	150
GRADE-5	1.05-1.45	11.5-14.0	1	0.08	0.025	-	1.8-2.1	-	229	150
GRADE-6	1.05-1.35	16.0-19.0	0.30-0.90	0.08	0.025	-	-	-	280	150
GRADE-7	1.05-1.35	16.0-19.0	0.30-0.90	0.08	0.025	1.5-2.5	-	-	280	150

## CARBON STEEL CASTING

ASTM SPECIFICATION	C (%)	Mn(%)	Si (%)	S (%)	P (%)	Cr (%)	Mo (%)	Ni (%)	HARDNESS	WAPL
EN-8	0.35-0.45	0.60-1.00	0.10-0.35	0.05	0.05	-	-	-	-	Wapl 48
EN-9	0.50-0.60	0.50-0.80	0.05-0.35	0.04	0.04	-	-	-	-	Wapl 49
EN-18	0.35-0.45	0.60-0.95	0.10-0.35	0.04	0.04	0.85-1.15	-	-	-	Wapl 50
EN-19	0.35-0.45	0.50-0.80	0.10-0.35	0.04	0.04	0.90-1.40	0.20-0.40	0.20-0.40	-	Wapl 51
EN-24	0.35-0.45	0.45-0.70	0.10-0.35	0.04	0.04	0.90-1.40	0.20-0.40	0.20-0.40	-	Wapl 52
EN-25	0.27-0.34	0.50-0.70	0.10-0.35	0.04	0.04	0.50-0.80	0.40-0.70	0.40-0.70	-	Wapl 53
EN-31	0.90-1.20	0.30-0.75	0.10-0.35	0.04	0.04	1.00-1.60	-	-	-	Wapl 54

## LOW ALLOY STEEL CASTING

WAPL GRADES	C (%)	Mn (%)	Si (%)	S (%)	P (%)	Cr (%)	Mo (%)	Ni (%)	HARDNESS	WAPL
IS-1030 1989 Gr-1	0.25	-	1	-	0.05	0.05	-	-	-	Wapl 55
IS-1030 1989 Gr-2	0.25	-	1.2	-	0.05	0.05	-	-	-	Wapl 56
IS-1030 1989 Gr-3	0.25	-	1.5	-	0.05	0.05	-	-	-	Wapl 57
IS-2707 1973 Gr-1	0.40-0.50	1.0 Max	0.6	0.05	0.06	0.06	-	-	-	Wapl 58
IS-2707 1973 Gr-2	0.50-0.60	1.0 Max	0.6 Max	0.05	0.05	-	-	-	-	Wapl 59
IS-2708 1993 Gr-1	0.18-0.25	1.2-1.06	0.6 Max	0.05	0.05	-	-	-	150-207	Wapl 60
IS-2708 1993 Gr-2	0.25-0.33	1.2-1.6	0.6 Max	0.05	0.05	-	-	-	179-229	Wapl 61
IS-2708 1993 Gr-3	0.26-0.33	1.2-1.6	0.6 Max	0.05	0.05	-	-	-	201-255	Wapl 62
IS-4896 1976 Cr. Moly Gr-1	0.45-0.55	0.50-1.00	0.75	0.05	0.05	0.80-1.20	-	200-250	-	Wapl 63
IS-4896 1976 Cr. Moly Gr-2	0.55-0.70	0.50-1.00	0.75	0.05	0.05	0.80-1.50	-	330-340	-	Wapl 64
IS-4896 1976 Cr. Moly Gr-3	0.90-1.20	0.50-1.00	0.75	0.05	0.05	0.80-1.50	-	340	-	Wapl 65

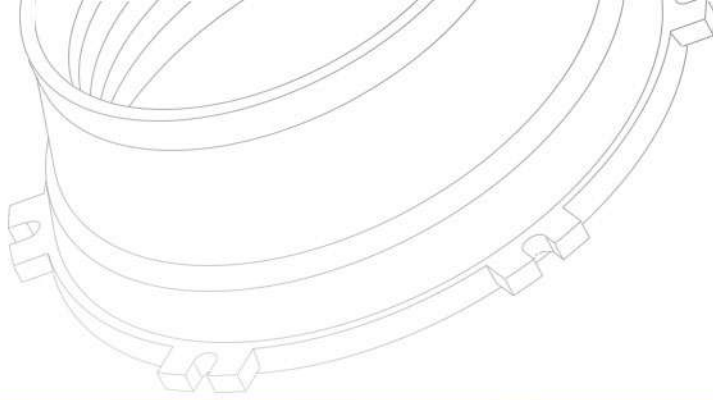

# SHRI RAJESHWARI Industrial Essentials



MANUFACTURER OF STONE CRUSHER PARTS | THERMAL POWER PLANT PARTS | CEMENT PLANT PARTS



#357, 2nd floor, 60 feet road,  
3rd Stage, BEML Layout,  
opp. Gold's Gym Rajarajeshwari nagar,  
Bangalore - 560 098



info@shrirajeshwariindustries.com



www.shrirajeshwariindustries.com



91-9886873789, 9113 222 547  
080-28602260

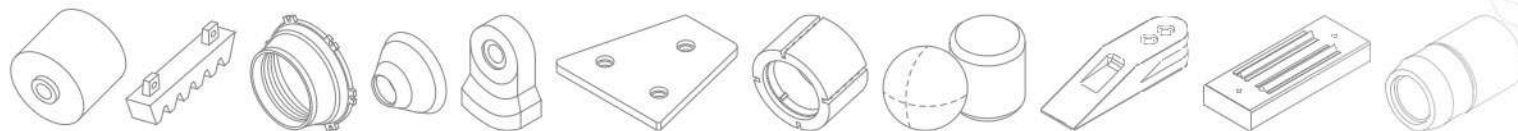

www.shrirajeshwariindustries.com